

VILLAGE OF CAROLINE
SPECIAL COUNCIL MEETING AGENDA
Thursday, April 29th , 2021, 7:30pm
Village of Caroline Council Chambers, 5004-50 Ave.
Virtual Meeting

Page # 1

1. CALL TO ORDER
2. ADOPTION OF AGENDA:
3. ADOPTION OF MINUTES:
3.1 Council Meeting Minutes April 22nd, 2021
4. DELEGATION(S):
4.1 Pithemeys Delegation: Ryan Leppke re: Alan Jewel Water Bill
Report from Financial Administrator re: Water Discrepancy.
5. STAFF REPORTS
5.1 None
6. COMMITTEE & BOARD REPORTS:
6.1 Mayor Report
6.2 Councillor Reports
7. BUSINESS:
7.1 Council Meeting Schedule.
7.2 Report from Stantec Re: Northeast County Development Services Study Update
8. DISCUSSION, CORRESPONDENCE, INFORMATION ITEMS:
8.1 Letter from the Reeve of the County of Painthearth re: Support for RCMP
8.2 Letter from TC Energy dated April 23rd.re: Project Notification
9. CLOSED SESSION
9.1 None
10. ADJOURNMENT

VILLAGE OF CAROLINE COUNCIL

Minutes of Special Council Meeting of Village Council, Province of Alberta, held virtually on April 22nd, 2021 at 5:30pm with information posted on Village Facebook Page for public live stream for attendees through Zoom.

Meeting Location: 5004-50 Ave.

Virtual Attendance:

Councilors: John Rimmer, Mary Bugbee, Mary Ann Wold, Donny Nichols.

Staff: CAO Craig Curtis, FO Christina Oxley

Absent: Councilor Parsons

In Person Attendance:

Municipal Clerk Sandy Buckberry

1. Call to Order

Mayor Rimmer called the meeting to order at 5:46pm

2. Adoption of Agenda

Motion 102.04.21

Moved by Councilor Bugbee to adopt Agenda as submitted.

CARRIED

3. Adoption of Minutes

Motion 103.04.21

Moved by Councilor Nichols to adopt April 15th, 2021 Council meeting minutes as re-submitted

CARRIED

4. Delegation(s):

4.1 None

5. Staff Reports

5.1. None

6. Committee & Board Reports

6.1 Mayor Report

- Meetings on closed landfill liability.
- Caroline Farmers Market Board and Agricultural Society proposal

CARRIED

6.2 Council Reports

Councilor Bugbee

- Reported on Westview lodge meeting and capital budget issues.

Councilor Wold

- Reported on Neighborhood Place meeting. The office may be closed to the public for the safety of staff. Library Board meeting postponed

VILLAGE OF CAROLINE COUNCIL

Minutes of Special Council Meeting of Village Council, Province of Alberta, held virtually on April 22nd, 2021 at 5:30pm with information posted on Village Facebook Page for public live stream for attendees through Zoom.

Councilor Nichols

- Nothing to report
- Councilor Parsons
- Absent

Motion 104.04.21

Moved by Councilor Wold to accept Mayor and Council reports as presented.

CARRIED

7. Business

7.1. Rocky Mountain House Waste Authority

Motion 105.04.21

Moved by Councilor Wold that the Council of the Village of Caroline, in consideration of the dissolution of the rocky Mountain Waste Authority, approve the following tri-party agreements with the Town of Rocky mountain House and the County of clearwater.

- Net Asset Distribution Agreement
- Closed industrial Cells Cost Sharing Liability Agreement.

CARRIED

7.2. Rocky Mountain House Waste Authority: Net Asset Distribution Agreement

Item addressed under 7.1.

7.3. Rocky Mountain House Waste Authority: Closed Industrial Cells Cost sharing liability Agreement

Item addressed under 7.1.

7.4. 2021 Operating and Capital Budget

The Interim Operating and Capital Budget for 2021 was approved by Village Council in December 2020. The budget is now submitted for final approval in order to establish the tax rate. The budget represents no increase in tax revenue from the Village.

Motion 106.04.21

Moved by Councilor Nichols that the Council of the Village of Caroline approve the 2021 Operating and Capital Budget as submitted

7.5 Tax Bylaw

CARRIED

Motion 107.04.21

Moved by Councilor Bugbee that the Council of the Village of Caroline approve first reading to Bylaw 2021-004: Tax Rate Bylaw

VILLAGE OF CAROLINE COUNCIL

Minutes of Special Council Meeting of Village Council, Province of Alberta, held virtually on April 22nd, 2021 at 5:30pm with information posted on Village Facebook Page for public live stream for attendees through Zoom.

CARRIED

Motion 108.04.21

Moved by councillor Wold that Council of the Village of Caroline approve second reading to Bylaw 2021-004: Tax Rate Bylaw

CARRIED

Motion 109.04.21

Moved by Councilor Nichols that Council proceed to third reading of Bylaw 2021-004: Tax Rate Bylaw.

CARRIED

Motion 110.04.21

Moved by Mayor Rimmer that Council of the Village of Caroline approve third and final reading of Bylaw 2021-004: Tax Rate Bylaw

CARRIED

8. Discussion, Correspondence, and Information Items

8.1 Fire Chief's Report: March

Motion 111.04.21

Moved by Nichols that the Council of the Village of Caroline accept the Fire Chief's march Report for information.

CARRIED

9. Adjournment

Motion 112.04.21

Moved by Councilor Nichols that the Council meeting be adjourned .

CARRIED

Time of Adjournment: 7:30pm.

MAYOR

CAO

Craig Curtis

From: Ryan Leppke <RyanL@pidherneys.com>
Sent: February 3, 2021 2:54 PM
To: Christina Oxley; joyce@telusplanet.net
Cc: Craig Curtis
Subject: RE: Water Issue
Attachments: DL_1548536324_20210126145245.pdf

Hello Christina,

I spoke with Alan Jewel and discussed:

- When the home was hooked up to temporary water (on or shortly after September 11.)
- When the home was taken off temporary water (on or shortly after October 19)
- Reviewed the water usage as per the attached meter readings

After discussion, we identified we need to understand if there were abnormal meter readings before or during the temporary water usage dates to see if that sheds some light on the meter readings. Can the Village provide the reading from July, August and September?



Ryan Leppke, PMP

Senior Project Manager / Estimator - Civil Construction, Pidherney's Inc.



Mobile: 403-588-5960 | Office: 403-885-3089

Main: 403-885-9101 | TF: 800-558-9033 | Fax: 403-885-9122

RyanL@pidherneys.com | www.pidherneys.com |   

56 - 27323 Twp Rd 394, Lacombe County, AB
PO Box 130, Blackfalds, AB, T0M 0J0

 **Driven to Excel from Start to Finish** Proudly Canadian Owned

From: Christina Oxley <assistant@villageofcaroline.com>

Sent: February 2, 2021 12:17 PM

To: joyce@telusplanet.net

Cc: Craig Curtis <ccurtis@villageofcaroline.com>; Ryan Leppke <RyanL@pidherneys.com>

Subject: Water Issue

CAUTION: This email originated from outside your organization. Exercise caution when opening attachments or clicking links, especially from unknown senders.

Good afternoon Alan & Joyce,

Sorry I missed your call this morning. In regards to the water issue and the response from Ryan (Pidherney's) which was as follows;

"Temporary water supply came off late October and was reverted back to municipal supply before end of the month. The invoice attached shows water usage for November to December, a time for which no temporary water was hooked up. If the meter is working correctly as demonstrated by True North Plumbing & Heating, that would indicate as substantial amount of water use by the residence, for which I cannot explain as temporary water connections were

disconnected. I'm curious to see if additional before and after information from billing period of November / December can provide further context. Can:

- We get a current meter reading as of today to compare usage so far this month?
- Can we get the previous bill for the period of September / October?

I'm wondering if the basement water plumbing has a branch between where the water pipe comes into the basement and before the meter that leads to the exterior hose bib for which we hooked the temporary water feed too? In that very non-typical case the meter could have potentially been running during September / October during construction and the meter reads would not have been accurate."

I have attached the documents of graphics and the prior bills. Everything I see suggests some kind of a leak inside the building (toilet or other). If there was some connection to what Pidherney's did with the temporary water with this address, I would expect to see a steady overage in the usage and / or still be prevalent after the plumber visited. As you can see further in the data the leak was rectified on the day the plumber was at the address. Please let me know if you have any further questions.

Kind Regards,

Christina Oxley,

Administrative Assistant
Village of Caroline
assistant@villageofcaroline.com
(403)722-3781

Note: The health and safety of our community, and visitors is our top priority. We kindly ask that you do not come into our office if you are experiencing flu-like symptoms; you have recently travelled to any location that has an active travel advisory related to COVID-19; or you know or suspect you have been in close contact with someone who has been diagnosed with COVID-19. We would be pleased to connect with you by email, phone or video conference. Thank you for your understanding and cooperation.

PIDHERNEY'S INC. NOTICE: This message and any files transmitted with it are confidential and intended solely for the use of the individual or entity to whom they are addressed. If you are not the named addressee, you are hereby notified that any dissemination, copying or distribution of this message, or associated files, is strictly prohibited. If you have received this message in error, please notify us immediately by replying to the message and deleting it. While Pidherney's Inc. has taken reasonable precautions to ensure no viruses are present in this email, Pidherney's Inc. cannot accept responsibility for any loss or damage arising from the use of this email or attachments. The views or opinions presented are solely those of the author and do not necessarily represent those of Pidherney's Inc.

To: Village Council
From: Christina Oxley, Financial Administrator
Re: Alan Jewell
Date: April 13th, 2021

Re: Water Discrepancy

The invoice attached shows water usage for before and after the time of interest, a time for which no temporary water was hooked up, temporary water supply came off late October and was reverted back to municipal supply before end of the month. If the meter is working correctly as demonstrated by True North Plumbing & Heating, that would indicate as substantial amount of water use by the residence, for which I cannot explain as temporary water connections were disconnected.

Resolution:

A couple of thoughts:

- The water usage level off to normal after the visit from the plumber.
- The interval of usage of the water over the period in question, it's not consistent like you would expect with some sort of exterior leak on the service line.

Everything I see suggests some kind of a leak inside the building (toilet or other). If there was some connection to what Pidhemeys did with the temporary water with this address, I would expect to see a steady overage in the usage and / or still be prevalent after the plumber visited.

A council direction is requested

To: Village Council
From: Craig Curtis, CAO
Re: Report from Stantec :
Northeast County Development Servicing Study Update

Date: April 13th., 2021

The 2021 Budget Report provided a brief description of the condition of the Village's Infrastructure. The 2009 Capital Infrastructure Plan needs updating, but several recent studies have been completed, in order to understand the capacity of existing services and the costs of maintenance and expansion.

Last year, Stantec was commissioned to undertake a study of servicing the northeast areas of the Village. The report titled "Northeast County Servicing Study Update (Revision2)" is still in draft form. A draft of the report was briefly circulated to Council on March 19th and James Coates of Stantec will make a full presentation at this meeting.

Recommendation:

That the Council of the Village of Caroline receive the draft report from Stantec titled "Northeast County Development Servicing Study Update (Revision2)" for information .

To: Village of Caroline From: Stantec Consulting Ltd.

File: 113927090_04 Date: January 29, 2021

Reference: Village of Caroline – Northeast County Development Servicing Study Update (Revision 2)

INTRODUCTION

Stantec was requested by the Village of Caroline to assess the capacity of the existing water and wastewater infrastructure and to identify if there's any upgrades required to service the proposed Northeast County Development located just outside the Village boundary. A technical memorandum was prepared and sent to the Village on July 25, 2017. After a review with the County of Clearwater, the County's consultant updated the servicing requirements to better reflect the requirements seen in municipalities of similar size and the Village of Caroline itself. This memo (Revision 1) has investigated the updated servicing requirements provided for by the County's consultant and revised the hydraulic water and wastewater models.

As per the previous study, the Capital Infrastructure Plan (CIP), prepared by Stantec in 2009, was reviewed and adopted in this technical memorandum. The hydraulic WaterCAD model developed for the aforementioned study was used as the basis for water infrastructure analysis. The sanitary sewers that would convey flow from the future development to the sanitary lagoon was modeled in PCSWMM to determine if the residual capacity is sufficient to accommodate future flows from Northeast County Development.

DESIGN FLOW OF NORTHEAST COUNTY DEVELOPMENT

The revised water and wastewater design basis from the developer are summarized in **Table 1** and **Table 2**. Design water demands for Average Day Demand (ADD), Maximum Day Demand (MDD) and Peak Hour Demand (PHD) scenarios and design peak wet weather sanitary flow (PWWF) for the Northeast County Development are summarized in **Table 3** and **Table 4**.

Table 1: Water Design Basis

Design Parameters	Revised	Design Value	Unit
Average Daily Consumption Rate	0.15		L/s/ha
MDD to PHD Peaking Factor	2		
PHD to MDD Peaking Factor	2		

Table 2: Wastewater Design Basis

Design Parameters	Revised	Design Value	Unit
Average Daily Flow	0.135		L/s/ha
Peak Day Dry Weather Design Flow	90 % of the PHD (Peak Hour Water Demand)		
Inflow/Infiltration	0.2		L/s/ha

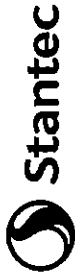

Reference: Village of Caroline – Northeast County Development Servicing Study Update (Revision 2)

Table 3: Northeast Development Design Water Demand

	Phase 2A Commercial	Phase 2B Commercial	Phase 2C Commercial	Phase 2D Commercial	Total
Development (ha)	5.15	2.48	5.2	12.15	24.98
ADD (L/s)	0.8	0.4	0.8	1.8	3.7
MDD (L/s)	1.5	0.7	1.6	3.6	7.5
PHD (L/s)	3.1	1.5	3.1	7.3	15.0
Fire Flow (L/s)	75				-

Table 4: Northeast Development Design Sanitary Flow Breakdown

	Phase 2A Commercial	Phase 2B Commercial	Phase 2C Commercial	Phase 2D Commercial	Total
Development Area (ha)	5.15	2.48	5.2	12.15	25.0
Average Flow (L/s)	0.7	0.3	0.7	1.6	3.4
Peak Day Dry Weather (L/s)	2.8	1.3	2.8	6.6	13.5
Inflow/infiltration (L/s)	1.0	0.5	1.0	2.4	5.0
Peak Design Flow (Peak Day Wet Weather Flow) (L/s)	3.8	1.8	3.8	9.0	18.5

CAPACITY ASSESSMENT OF EXISTING WATER DISTRIBUTION SYSTEM AND WATER TREATMENT PROCESS

Water demands for ADD, MDD and PHD conditions are summarized in **Table 5** and are available in a WaterCAD hydraulic model. It is suggested in the 2009 Capital Infrastructure Plan (CIP) that the average day demand of treated water consumption is 470 LPCD based on the available potable water consumption data from 2005 to 2008. The per capita consumption rate will remain at 470 LPCD from 2009 to 2019 considering there is no large commercial and industrial development in the short term for the Village. The available existing model scenario demand was previously developed with a total population of 540 using water consumption rate of 470 LPCD. The total demands of the existing system plus the Northeast County Development is summarized in **Table 5**. The equivalent population in Northeast County Development will reach 680 using a consumption rate of 470 LPCD. The total equivalent population in the Village of Caroline will become 1,220 when the Northeast County Development area is fully developed. This value is conservative since the current 2016 Caroline's population of 512 is lower than the simulated population in the existing model.

Table 5: Water Demand Summary

	Existing System Demand	Northeast Development Demand	Grand Total Existing System plus Northeast County Development
Average Day Demand (L/s)	2.94	3.7	6.64
Maximum Day Demand (L/s)	5.88	7.5	13.4
Peak Hour Demand (L/s)	12.03	1.5	27.0
*Treated Water Consumption Rate (Lcpd)	470	470	470
Population /Equivalent Population	540	680	1,220

Reference: Village of Caroline – Northeast County Development Servicing Study Update (Revision 2)

Note that since the Northeast County Development will be primarily a commercial and industrial subdivision, the treated water consumption rate is most likely to be lower than 470 LPCD. From our understanding, service meters have been installed in the Village since the 2009 CIP study. A water consumption audit/analysis is recommended to be conducted to examine the actual water consumption rate within the Village to better quantify the requirements of the water system.

As identified in the 2009 CIP, the Village has three water wells (Well 401, 402 and 403). Well 401 was abandoned in 2007. Well 403 is being used frequently and was recorded to pump approximately 300 m³/day, at 5 hours per day (varies by season). The level of manganese concentration in Well 402 was recorded to be high, thus the current manganese removal process used in Well 403 didn't work efficiently in Well 402. As recorded in the 2009 CIP, the water level in Well 403 remained stable whether the pumps were kicked on or not. Also, the capacity of the current water supply wells were identified as sufficient to service more than 1,000 persons. In this study, the total population is projected to reach approximate 1,220 with full build-out of Northeast County development. It is recommended that the water level in Well 403 is observed/monitored by the Village to ensure the level remains stable as future growth occurs.

Regarding the water treatment filtration process, the combined capacity of the two existing filter tanks were recorded at a total of 655 m³/d (7.6 L/s) in the 2009 CIP study. The two filter tanks could not handle the total design MDD of 13.4 L/s for the full build-out of the Northeast County development. As the existing projected MDD is 508 m³/d (5.88 L/s), the current two filter tanks could still provide additional 149 m³/d (1.72 L/s) for new developments in the development. Hence, an additional filtration capacity of 501 m³/d (5.8 L/s) is needed to service the Village and the proposed Northeast County Development.

The CT value (Chlorine Concentration Contact time) was calculated to be 38 at PHD condition (27.0 l/s), assuming a baffle factor of 10% and 0.5 mg/L free chlorine entering the distribution system. This value is higher than the required value of 10, thus meeting the ability to claim the 4-log reduction of virus's credit, as required by AEP guidelines.

New model scenarios for the Northeast County Development were created for ADD, MDD and PHD analysis. The level of service design criteria for this study is summarized in **Table 6**, developed based on typical industrial standard.

Table 6: Level of Service Design Criteria

	Value	Unit
Minimum System Pressure for PHD	43.5	psi
Maximum Allowable Pressure	123	psi
Minimum Pressure in a fire flow condition	21.8	psi
Maximum Allowable Velocity in normal operation	1.5	m/s
Maximum Allowable Velocity for Future Pipes in a fire flow condition	2.5	m/s
Fireflow for Commercial/Industrial Area*	75	L/s

* Note the proposed 75 l/s is revised and agreed by the County and the County's consultant.

Reference: Village of Caroline – Northeast County Development Servicing Study Update (Revision 2)

As recorded in 2009 CIP, the existing pump system of the Town consists of two 10 hp vertical turbine distribution pumps along with one 125 hp fire flow pump connected to an eight cylinder diesel engine. There is also one backwash pump to pump water back to the filter tanks for filtration purposes. Alberta Environment and Parks (AEP) standard recommends the pump station should provide adequate pumping capacity when the largest pump is taken off line. In order to accommodate total PHD flow of 27 L/s, the two existing distribution pumps are recommended to be replaced with bigger pumps rated at 27 L/s, 42 m head with approximate 18 hp based on ground elevation to meet the specified minimum pressure criteria shown in **Table 6**. It is recommended that this proposed pump design set point be further reviewed and confirmed in the design stage. A conceptual water servicing strategy developed in the Northeast County Development is presented in **Figure 1**. The proposed water mains consist of approximate 1,675 m of 200 mm. The existing 265 m of 150 mm water mains will be required to upsize to 200 mm to supply an adequate fire flow of 75 L/s to the new development area, as shown in **Figure 1**.

The looping around the Northeast County Development is proposed to ensure an adequate fire flow of 75 L/s being supplied. Based on the aforementioned water servicing strategy, all level of service (LOS) of design criteria summarized in **Table 6** can be met.

As the required fire flow was revised to 75 L/s, the existing reservoir does have fire storage for 1.75 hours at 75 L/s, equivalent to 473 m³. The effective volume of the existing reservoir is 820 m³. Based upon Alberta Environment and Parks (AEP) standard, **Table 7** summarizes the existing and future storage requirements. As such, the existing reservoir could provide sufficient storage volume for the existing water supply system.

From **Table 7**, it is calculated that an additional 208 m³ of storage is required to provide sufficient capacity to service the Northeast County Development to meet AEP standard. Considering the effective volume of the existing reservoir of 820 m³, there's only 26 m³ (3%) storage deficiency in servicing the existing system plus the Northeast County development. Based on our past design experiences, this 3% storage deficiency can be deemed negligible. Therefore the effective volume of the existing reservoir of 820 m³ is sufficient to provide servicing to the Northeast County development.

Table 7: Existing and Future Storage Requirements

	Existing Storage Requirement (m ³)	Future Storage Requirement (m ³)
A = Fire Storage	1,473	1,473
B = Equalization on Storage (25% MDD)	127	287
C = Emergency Storage (15% ADD)	38	86
Total Required Storage	638	846
Existing Storage	820	820
Additional Storage Required	-182	26

Note:

1. The existing fire storage was calculated based on 75 L/s for 1.75 hours, equivalent to 473 m³.

Reference: Village of Caroline – Northeast County Development Servicing Study Update (Revision 2)

CAPACITY ASSESSMENT OF SANITARY LAGOON TRUNK

Based on the available as-built drawings for the wastewater collection system, a sanitary model was developed using PCSWMM to determine the residual capacity of the existing sewer trunk along 49th Street, beginning from north of 50th Ave to the downstream sanitary lagoon, identified in **Figure 2**. Note that the existing sanitary trunk was replaced with 300 mm PVC pipes from the end of 49th Street to the sanitary lagoon in 2012.

The existing sanitary peak wet weather flow (PWWF) was projected using the assumed design parameters summarized in **Table 8**. The projected PWWF is summarized in **Table 9** considering current 2016 village's population of 512. Note that the existing PWWF is calculated using typical industrial standards. It is recommended an on-going flow monitoring program to be conducted to investigate the actual sanitary flows to facilitate future design/planning studies in a long run.

Based on the modeling results, the PWWF Hydraulic Grade Line (HGL) profile was presented in **Appendix Figure B-1**. With a total design sanitary flow of 33.3 L/s, no surcharging was observed along the identified sanitary sewer trunk with consideration of design PWWF flow of 18.5 L/s in Northeast County Development; however, a condition assessment was completed as part of the 2009 Capital Infrastructure Plan and it noted the condition of the sanitary mains along 49 Street from Main Street south was in poor to very poor condition.

Table 8: Existing Wastewater System Design Parameters

	Assumed Design Parameters	Unit
Average Dry Weather Flow Rate (Residential)	300	Liter per capita per day
ICI Flow Generation Rate	0.1	Liters per second per hectare
Peaking Factor	2.5	
I&I Allowance	0.2	Liters per second per hectare

Table 9: Total Design Peak Wet Weather Flow

	Projected PWWF (L/s)
Existing System	14.8
Northeast County Development	18.5
Grand Total	33.3

Wastewater Treatment

It was noted in the 2009 Capital Infrastructure Plan, the sewage treatment facility had capacity for a population of approximately 879 persons using the existing aerated lagoon and a continuous discharge system at the time the 2009 study was conducted. AEP recently required further studies with more stringent requirements as noted in more detail below. Therefore the

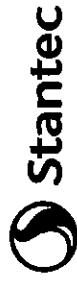

Reference: Village of Caroline – Northeast County Development Servicing Study Update (Revision 2)

erated lagoon system will not have sufficient capacity to treat the existing wastewater let alone the added flows from the new development with an equivalent population of 1,220.

As requested by Alberta Environment and Parks, the Village is in the process of conducting a "receiving water study" on the existing sewage treatment lagoon system, as per the Wastewater System Effluent Regulation under Fishery Act (WSER 2012). This study will determine if the existing lagoon system has the capacity to treat the wastewater requirements laid out in the WSER standard. The receiving water study might lead to treatment technology changes to effectively lower the ammonia level all year round to ensure the treated effluent can pass the lethal tests using rainbow trout. New treatment system based on proper technology has to be sized with the total 1,220 equivalent population.

OPINION OF PROBABLE COSTS

Based on the information in the aforementioned sections, an opinion of probable costs has been presented in the below table. The costs below are for the Village of Caroline's portion of the required upgrades. The represented costs are a Class D level estimation of the expected costs.

Item	Item Description	Cost
1.	WTP Upgrades	\$190,000
1.1	Electrical Upgrades (incl. MCC upgrade, VFD replacement, Programming, Cabling)	\$70,000
1.2	Pumps and Pump Bases	\$120,000
2.	Water Mains Replacement/Installation (1.2km)	\$1,200,000
3.	Sanitary Mains Replacement (0.5km)	\$920,000
	Subtotal 1	\$2,310,000
4	Engineering (10%)	\$181,000
5	Contingency (30%)	\$693,000
	Total (excl. GST)	\$3,184,000

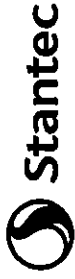

Reference: Village of Caroline – Northeast County Development Servicing Study Update (Revision 2)

CONCLUSIONS AND RECOMMENDATIONS

Based on the updated design water demands using revised design basis and capacity assessment of the existing water infrastructure in the Village of Caroline through hydraulic WaterCAD model, our findings are summarized as follows:

- As the servicing meters were installed after 2008, it is recommended to do a water consumption audit/analysis to examine the actual water consumption rate after the installation of the service meters;
- To service the Northeast County Development, the proposed water mains consist of approximate 1,200 m of 200 mm new water mains outside the development boundary. The existing 265 m of 150 mm water mains will be required to upsize to 200 mm to supply an adequate fire flow of 75 L/s to the new development area.
- As the water well capacity in Well 403 was identified as sufficient to service more than 1,000 persons, it is recommended that the water level in Well 403 is continually observed/monitored by the Village to ensure water level remains stable as future growth occurs;
- The two existing water distribution 10 hp pumps are recommended to be replaced with bigger pumps rated at 27 L/s with 42 m head with approximate 18 hp from ground elevation to provide firm pumping capacity at PHD scenario with demands from the existing system and Northeast County Development. It is recommended that this proposed pump design set point be further reviewed and confirmed in the design stage;
- With revised fire flow requirement of 75 L/s for future commercial and industrial customers in the Northeast County Development, the current storage volume of 820 m³ is deemed sufficient;
- The combined capacity of the two filter tanks in the water treatment process could not handle the total design MDD demand. Potential upgrade on the two filter tanks is recommended. It is suggested the Village to conduct a treatment process upgrade study to identify the scope and detailed requirements of the upgrades.



January 29, 2021
Village of Caroline
Page 8 of 8

Reference: Village of Caroline – Northeast County Development Servicing Study Update (Revision 2)

Based on the updated design wastewater flows using revised wastewater design basis from the county's consultant's and capacity assessment of the existing sewer trunk along 49th Street starting from 50th Ave to downstream sanitary lagoon in the Village of Caroline through PCSWMM model, our findings are summarized as follows:

- With the total design sanitary flow of 33.3 L/s, no surcharging was observed along the identified sanitary sewer trunk with consideration of design PWWF flow of 18.5 L/s from the Northeast County Development; however, the mains along this section is in very poor condition and it is recommended to replace the infrastructure prior to increasing the flow through; and
- The existing lagoon system doesn't have sufficient capacity to support the full build-out of Northeast County Development. The required sewage treatment capacity upgrades will be determined by the on-going receiving water study. The receiving water study might lead to the changes of treatment technology to effectively lower the ammonia level all year round to ensure the treated effluent can pass the lethal tests using rainbow trout. New treatment system with proper technology will be sized to accommodate the total population of 1,220 with total projected PWWF flow of 33.3 L/s in this study.

The Opinion of Probable Costs (Class D Estimate) for the upgrades noted in this study is \$3,184,000

REFERENCE

- Village of Caroline Capital Infrastructure Plan, Stantec, 2009

STANTEC CONSULTING LTD.

James Coates, M.Sc., P.Eng.
Project Engineer
Phone: (403) 356-3366
james.coates@stantec.com

Attachment: Figure 1 – Proposed water servicing
Figure 2 – Wastewater Servicing Capacity Analysis
Figure B-1 - Sanitary Sewer Trunk HGL Profile with Total Design PWWF

cc. Joel Sawatzky, Sophie Sadowski

Future Alignments are intended to be conceptual.

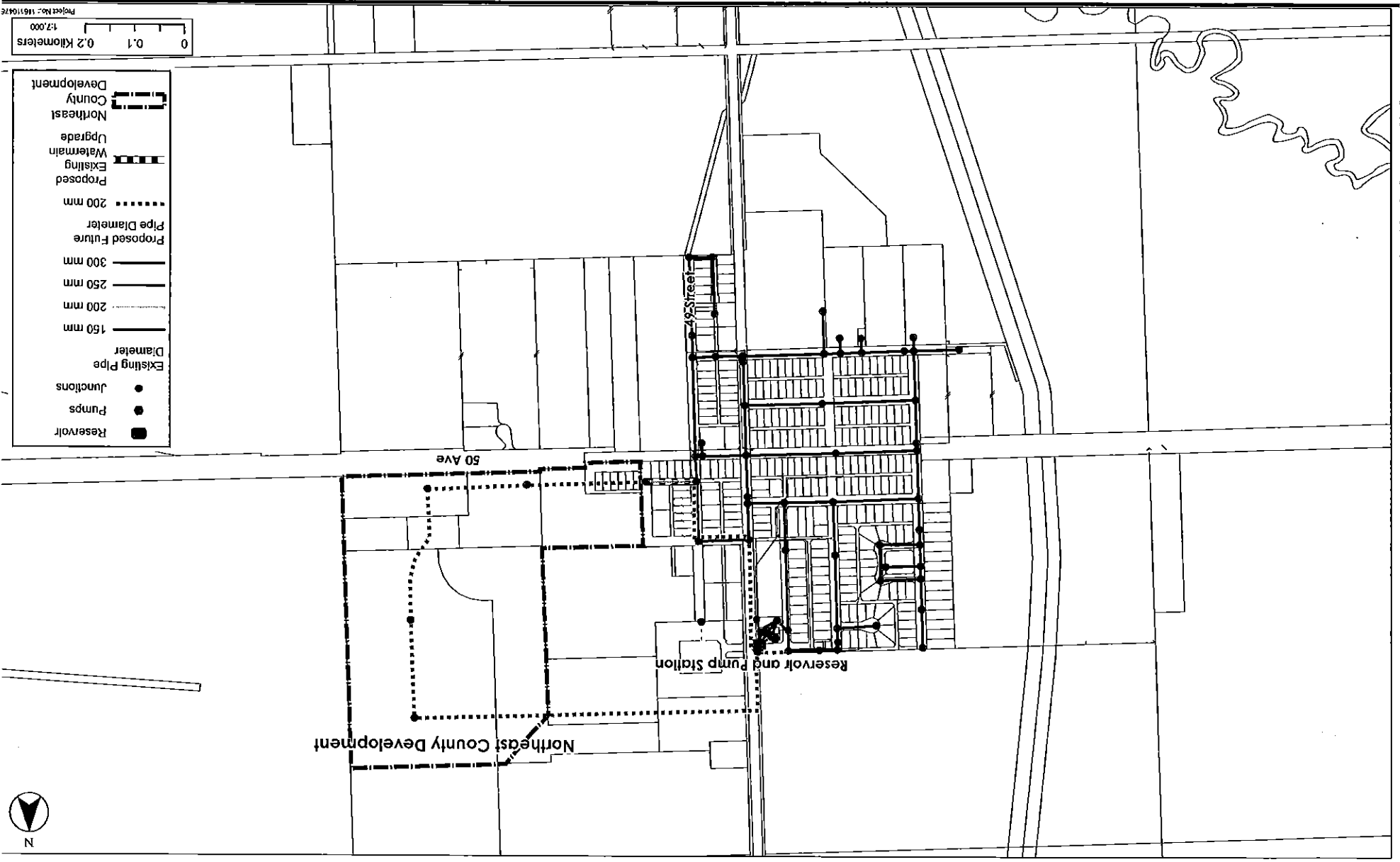

Northwest County Development

Reservoir and Pump Station

50 Ave

455 Street

- Reservoir
- Pumps
- Junctions
- Existing Pipe Diameter
- Proposed Future Pipe Diameter
- Proposed Existing Watermain Upgrade
- Northwest County Development

0 0.1 0.2 Kilometers
 1:7,000



11/15/2011 10:45:00 AM
 C:\Users\jsteele\Documents\116110476\116110476.dwg
 11/15/2011 10:45:00 AM
 jsteele

Figure 2 Northeast County Development Wastewater Servicing Capacity Analysis Layout

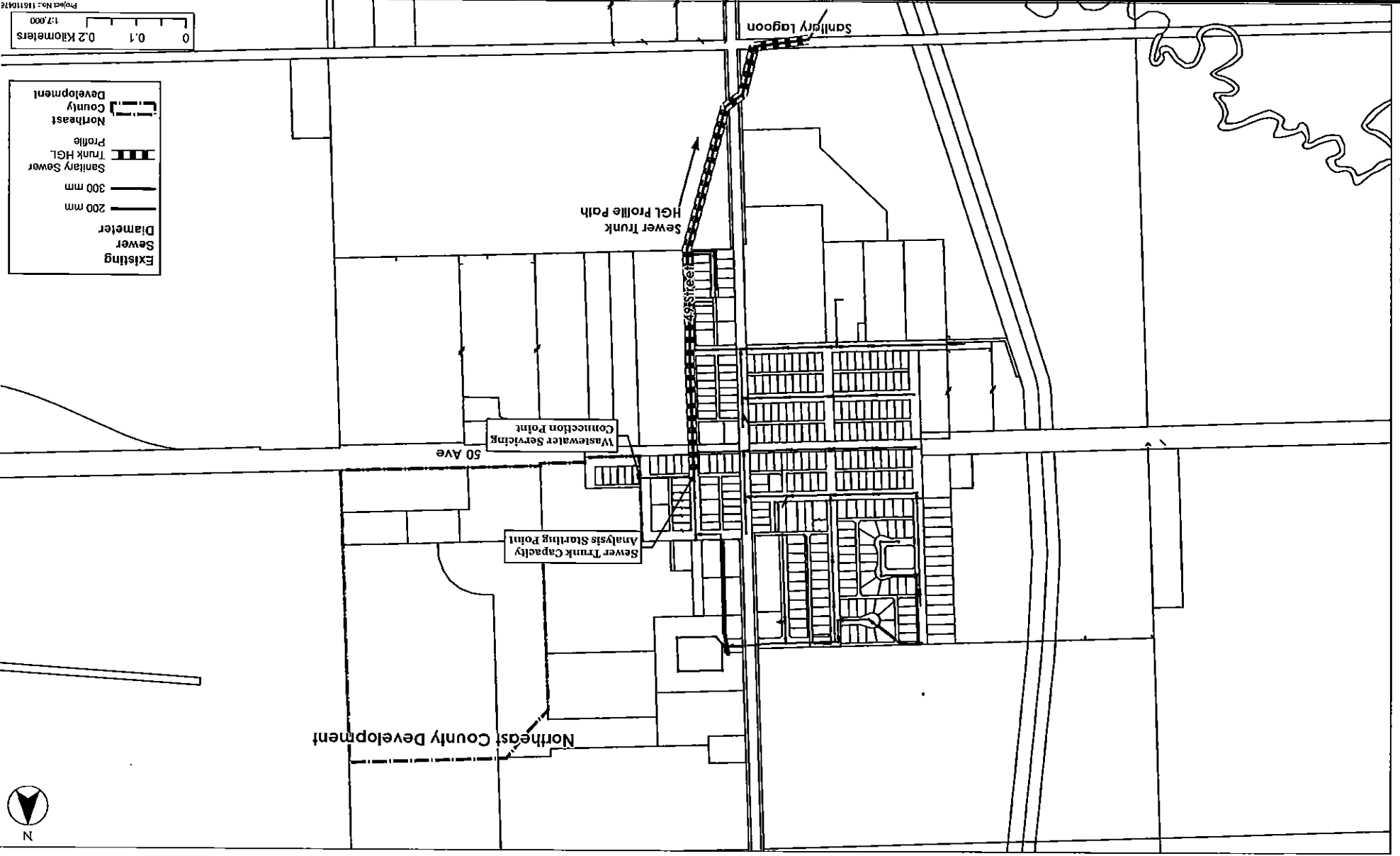

11/15/2017 10:53:00 AM
 C:\Users\jdoyle\OneDrive\Documents\Projects\116110176\116110176.dwg
 11/15/2017 10:53:00 AM



Stantec Consulting Ltd.
 Suite 1100, 4900-50 Street
 Red Deer AB Canada
 T4N 1X7
 Tel. 403.341.3320
 www.stantec.com

Client/Project
 Village of Caroline
 Sanitary Sewer Trunk Capacity Assessment
 Figure No. B-1
 Title
 Sanitary Sewer Trunk HGL Profile with Total Design PWWF
 (Sewer Trunk along 49th Street from north of 50th Ave to
 Sanitary Lagoon)

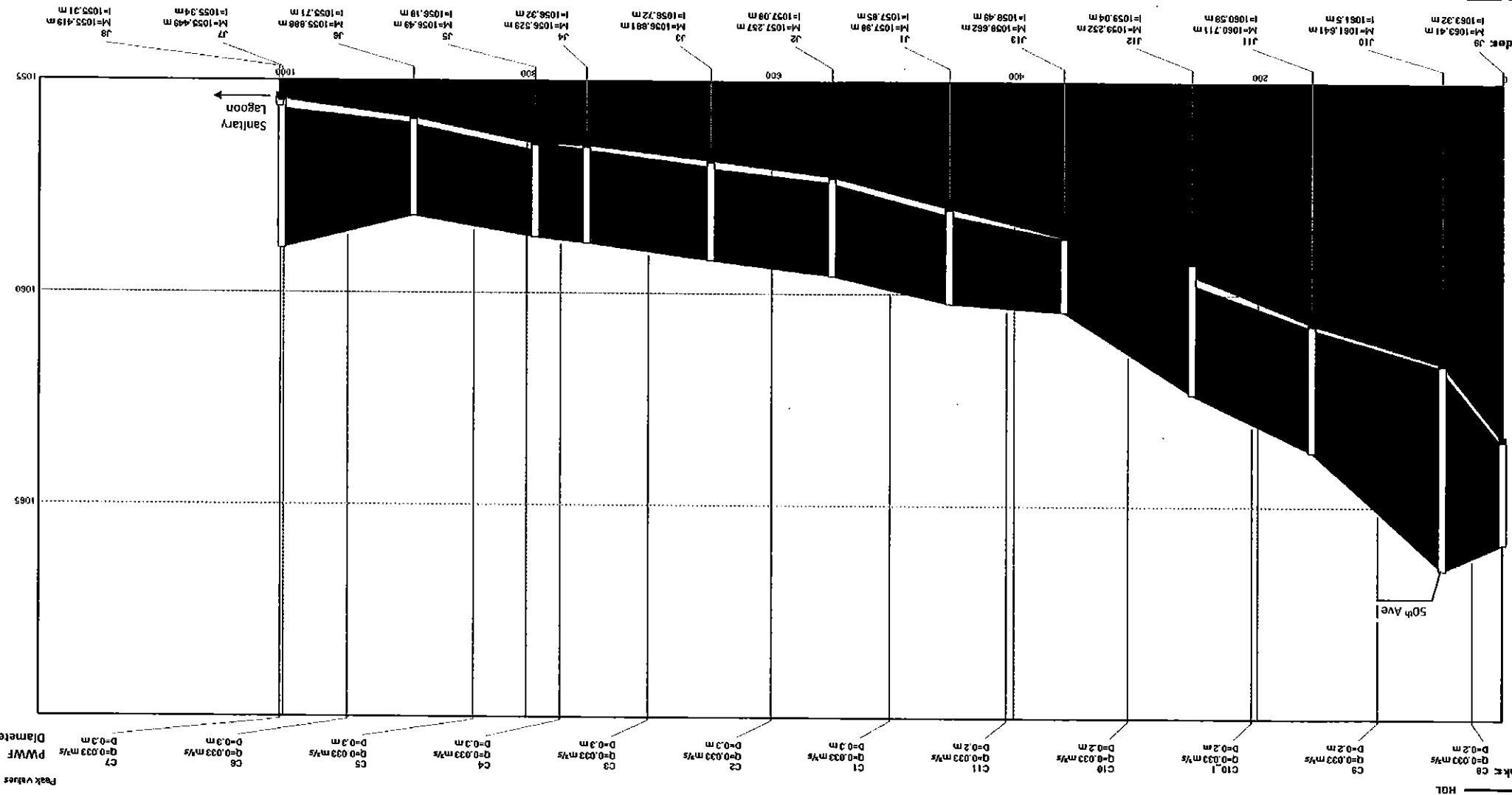

County of Paintearth
No. 18

#1 Crowfoot Drive, Crowfoot Crossing
Box 509 Castor, AB T0C 0X0
P: 403.882.3211
F: 403.882.3560
www.countypaintearth.ca

April 21, 2021

Honourable Kaycee Madu
Minister of Justice and Solicitor General
424 Legislature Building
10800-97 Avenue
Edmonton, Alberta T5K 2B6

Dear Minister, Madu:

Re: County of Paintearth's Support for the RCMP

Our Council wishes to advise they are also not in support of the Government of Alberta's initiative to replace the RCMP with an Alberta Provincial Police Service (APPS) as affirmed in Mayor Turner's letter from the Town of Morinville.

Council agrees that by revising the *Police Act*, the outcomes as identified through the review can be achieved such as improving the public's trust in policing, ensuring an effective complaint process, and having a more harmonious relationship between the police and all communities within Alberta.

Council too has concerns with the province establishing an APPS despite 65% of respondents indicating non-support. The costs of transitioning to an APPS are unknown and the increased operating costs will undoubtedly be borne by the municipalities. The municipalities are currently bearing a substantial amount of policing costs and are not willing to accept unknown additional increases that will be inevitable from a transition to an APPS. This simply cannot be done within a short time frame to offer the expertise and services currently provided to Albertans by the RCMP.

Our County has developed a collaborative relationship with our local RCMP detachment over many years and is satisfied with the level of service and degree of responsiveness received and their involvement with the communities located in the County. Council echoes and encourages the Government of Alberta to abandon the transition study and redouble efforts to work with the RCMP to achieve better outcomes.

Yours truly,

COUNTY OF PAINTEARTH NO. 18



Stan Schulmeister
Reeve

cc: The Honourable Jason Kenney, Premier
MLA Nate Horner, Drumheller- Stettler
MP Damien Kurek, Battle River-Crowfoot
Mr. Curtis Zablocki, Commanding Officer for Alberta, RCMP
AUMA Members
RMA Members



TC Energy
450 - 1 Street S.W. Calgary, AB
Canada, T2P 5H1
Tel: 844-933-0954
Community_Relations@transcanada.com

April 23, 2021

[SENT BY EMAIL]

Project Notification Update: Edson Mainline Expansion Project in-service delay

NOVA Gas Transmission Ltd. (NGTL), a wholly owned subsidiary of TransCanada Pipelines Limited (TCPL), an affiliate of TC Energy Corporation is proposing to construct, own and operate the Edson Mainline Expansion (EDML) Project. The pipeline expansion in western Alberta is required to expand pipeline capacity for the transportation of natural gas to growing markets located in central and southern Alberta from the Peace River Project Area (PRPA).

We have made some changes to the project in light of concurrent and competing projects in the pipeline construction industry. Below are the new project details and attached is the updated fact sheet to reflect said changes.

NGTL is expecting a seven-month delay to the in-service date of the EDML project to November 1, 2022, as a result of limited prime construction contractors availability in this dynamic and evolving construction environment.

For more information on the Project please visit <https://www.tcenergy.com/edson-mainline-expansion>.

TC Energy is a leading North American energy infrastructure company with over 65 years of experience and has an industry leading safety record. We are committed to building and operating our natural gas system safely. From design and construction to operation and maintenance, safety is an integral part of everything we do.

We strive to engage stakeholders throughout the life of the project. We believe engagement is a two-way process and invite you to share questions and concerns with us so that we can provide information, follow up, and incorporate input into our plans. Please do not hesitate to contact us at 1-844-933-0954 or by email at EdsonMainlineExp@tcenergy.com in regards to the project.

Sincerely,

Preston Seier
Public Affairs – Canada West
TC Energy